

## Standard Series - Model:208005

**Undermount** Rear positioned drain holes to maximize usable bowl and cabinet storage space below

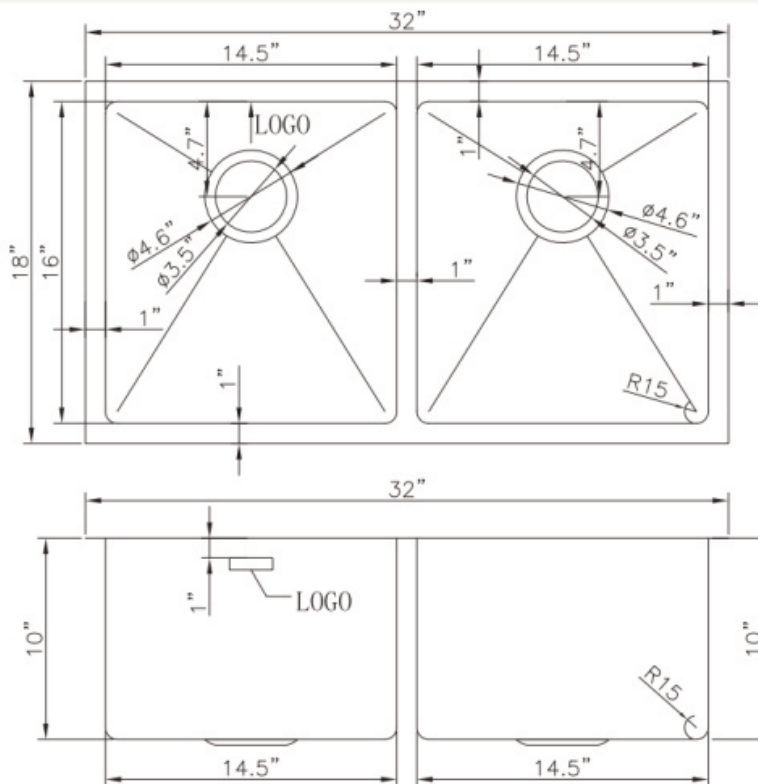
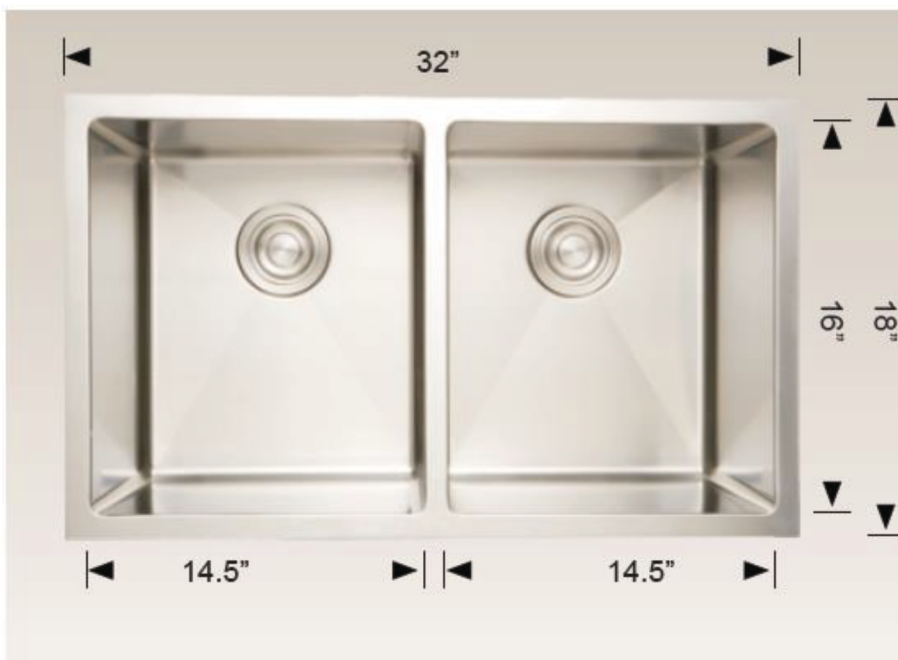

### Specifications:

- Handcrafted
- 304 Stainless Steel
- 18 Gauge
- Bowl Corner Radius of 15mm
- Stainless Steel Strainers
- Undermount Clips
- Template
- 10" Deep

Outside: 32" x 18" x 10"

Inside: 30" x 16" x 10"

Bowl Size: 14.5" x 16" x 10"

14.5" x 16" x 10"

Minimum cabinet size 35"

### Certification/Warranty

- ASME A 112.19.3
- CSA B45.4
- Limited Lifetime Warranty

### Included Accessories

#### 208005 Plus



Strainer  
Model: 202012

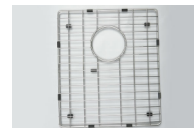

Grid  
Model: G208005



Plate Holder  
Model: 202041

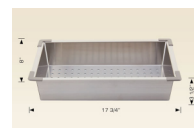

Basket  
Model: 202040

### Optional Accessories



Utensil Rack  
Model: 202015



Cutting Board  
Model: 202020

*Bosco Canada Inc. is known around the world for producing high quality kitchen sinks that incorporate modern design and functional superiority in every piece they manufacture.*