

## Deluxe Series - Model: 201715 Plus Radius Corner

Rear positioned drain holes to maximize  
usable bowl and cabinet storage space below

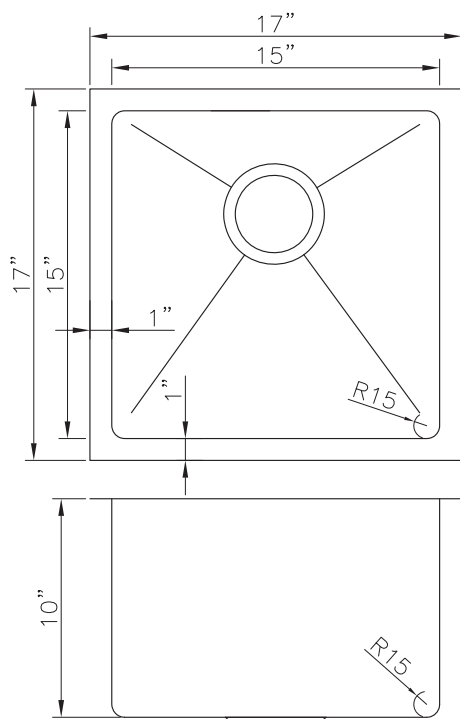

### Specifications:

- Handcrafted
- 304 Stainless Steel 18 Gauge
- 18/10 Chrome Nickel Content
- Bowl Corner Radius of 15 mm
- Undermount Clips
- Template
- Stainless Steel Strainer
- 10" Deep

Outside: 17" x 17" x 10"  
Inside: 15" x 15" x 10"

Minimum cabinet size 20"

### Certification/Warranty

- ASME A 112.19.3
- CSA B45.4
- Limited Lifetime Warranty

### Included Accessories



**Model: G201715**  
Grid



**Model: 202012**  
Strainer

*Bosco Canada Inc. is known around the world for producing high quality kitchen sinks that incorporate modern design and functional superiority in every piece they manufacture.*